

1/5/2024 5:28:54 PM



**3 BUILDING #3 (SOUTH), #4 (WEST) FACADE**  
1/8" = 1'-0"



**4 BUILDING #3 (WEST), #4 (NORTH) FACADE**  
1/8" = 1'-0"

ELEVATION LEGEND	
ID	DESCRIPTION
5.03	42" HIGH RAILING (REFER TO ELEVATION FOR TYPE)
8.13	ALUMINUM / GLASS SLIDING DOOR (GC TO SUBMIT SHOP DRAWINGS)
8.16	ALUMINUM / GLASS STOREFRONT DOOR (GC TO SUBMIT SHOP DRAWINGS)
8.50	WOOD LOUVER PANEL SWING DOOR
8.80	ALUMINUM / GLASS FIXED WINDOW (GC TO SUBMIT SHOP DRAWINGS)
8.81	ALUMINUM / GLASS HORIZONTAL SLIDER WINDOW (GC TO SUBMIT SHOP DRAWINGS)

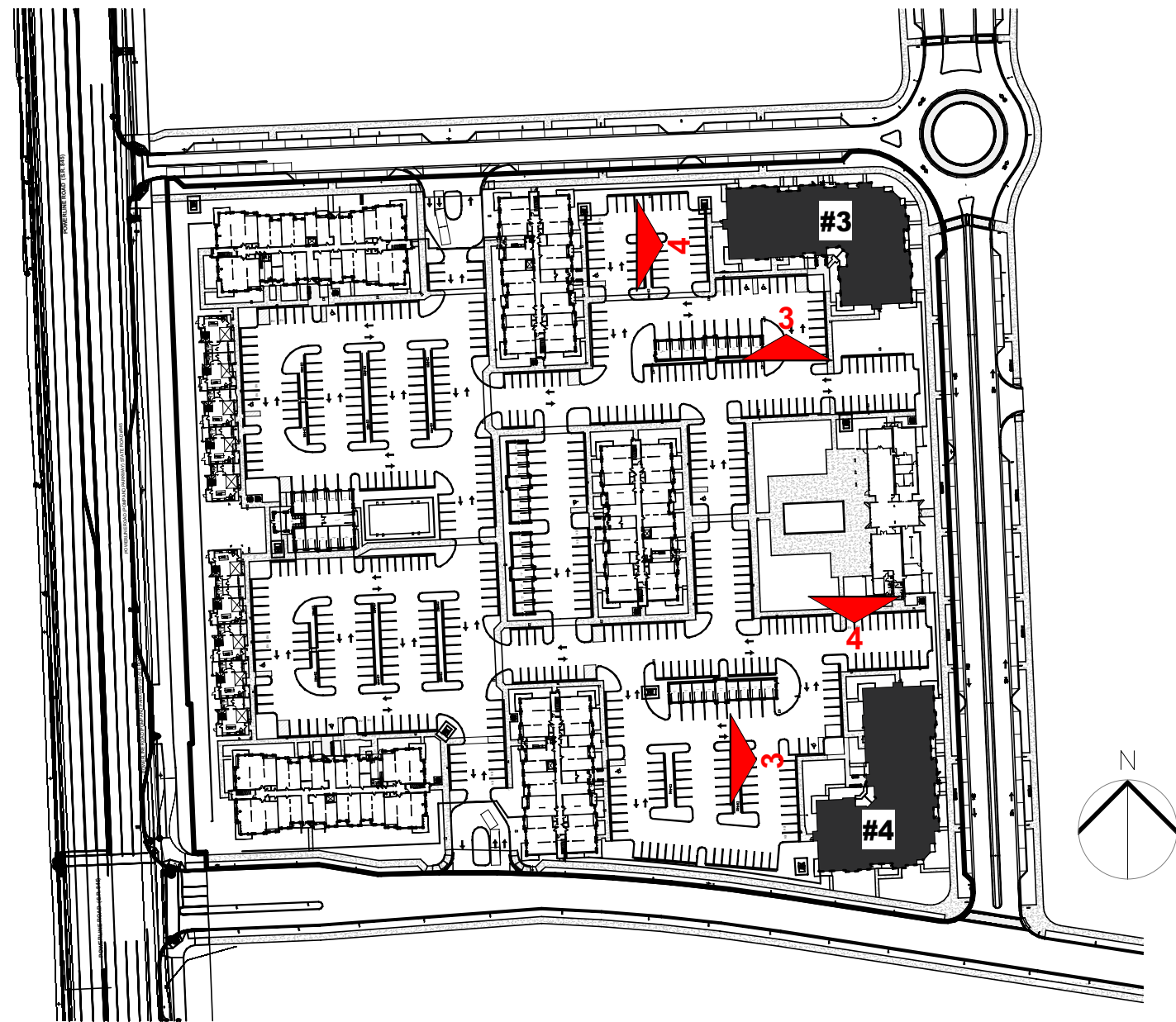

**SITE PLAN BLDG #2, #5, #7**

REVISIONS		
NO.	Description	Date

**Live!**  
**INDIGO POMPAÑO BEACH**  
POMPAÑO BEACH, FL  
ATLANTIC RESIDENTIAL

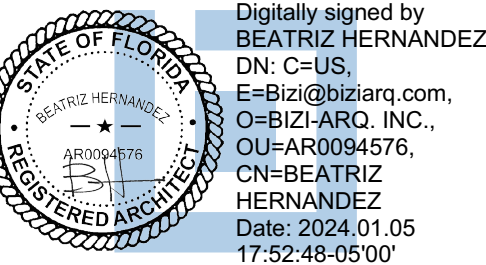

BEATRIZ M. HERNANDEZ  
AR0094576

COPYRIGHT 2023 BIZI ARQ, INC.  
THE ARCHITECTURAL DESIGN AND DETAIL DRAWINGS FOR THIS BUILDING AND/OR OVERALL PROJECT ARE THE LEGAL PROPERTY OF AND ALL RIGHTS ARE RESERVED BY THE ARCHITECT. THE USE FOR REPRODUCTION, CONSTRUCTION, OR DISTRIBUTION IS PROHIBITED UNLESS AUTHORIZED BY THE ARCHITECT. THEIR USE FOR REPRODUCTION, CONSTRUCTION, OR DISTRIBUTION IS PROHIBITED UNLESS AUTHORIZED IN WRITING BY THE ARCHITECT.

ARCHITECTS BUILDING CODE TO THE BEST OF THE ARCHITECT'S KNOWLEDGE, THE PLANS AND SPECIFICATIONS COMPLY WITH FLORIDA BUILDING CODE SEVENTH EDITION (2020) AND THE APPLICABLE FIRE SAFETY STANDARDS AS DETERMINED BY THE LOCAL AUTHORITY AND CHAPTER 633, FLORIDA STATUTES.

PROJECT NO. 23-1006  
SCALE As indicated  
DATE 2023.08.12  
AAC SUBMITTAL - 2024.01.08  
SHEET NAME

**BUILDING TYPE III  
ELEVATIONS**

SHEET NO.  
**A.III.4-104**

**AAC**  
PZ23-12000039  
02/06/2024